

NEPA COMPLIANCE SURVEY

276

Project Information	
Project Title: Flowline leak @ 68-66-SX-34	Date: 1/26/2010
DOE Code:	Contractor Code:
Project Lead: Jeff Jones	
<p style="text-align: center;">Project Overview</p> <ol style="list-style-type: none"> 1. What are the environmental impacts? 2. What is the legal location? 3. What is the duration of the project? 4. What major equipment will be used if any (work over rig, drilling rig, etc.)? 	<p style="text-align: right; color: red; font-weight: bold;">OIL-</p> <p>Elimination of the flowline @ 68-66-SX-34. Dig up and locate leak. Take contaminated soil to land farm and record in log book. The duration of this project will be approx. 4-days. The equipment to be used is as follows backhoe, and welder. We will be eliminating the flowline and pumping to a tank set on location. So we don't have any leaks in the future.</p>

The table below is to be completed by the Project Lead and reviewed by the Environmental Specialist and the DOE NEPA Compliance Officer. NOTE: If Change of Scope occurs, Project Lead must submit a new NEPA Compliance Survey and contact the Technical Assurance Department.

	Impacts Anticipated?			If YES, then complete below
	Yes	No	NA	If the anticipated impact might be unacceptable, recommend mitigation measures:
Water Quality				
Does the proposed project present potential for impacts on water resources or water quality?	<input type="checkbox"/>	<input checked="" type="checkbox"/>	<input type="checkbox"/>	
Does the project affect surface water quantity or quality under both normal operations and accident conditions?	<input type="checkbox"/>	<input checked="" type="checkbox"/>	<input type="checkbox"/>	
Does the proposed project affect groundwater quantity or quality under both normal operations and accident conditions?	<input type="checkbox"/>	<input checked="" type="checkbox"/>	<input type="checkbox"/>	
Will the project area include "Waters of the State?"	<input type="checkbox"/>	<input checked="" type="checkbox"/>	<input type="checkbox"/>	
Will the project area require a Corps of Engineers permit?	<input type="checkbox"/>	<input checked="" type="checkbox"/>	<input type="checkbox"/>	



NEPA COMPLIANCE SURVEY

	Impacts Anticipated?			If YES, then complete below.
	Yes	No	NA	If the anticipated impact might be unacceptable, recommend mitigation measures:
Geology & Soils				
Does the proposed project present potential for impacts related to geology or soils?	<input checked="" type="checkbox"/>	<input type="checkbox"/>	<input type="checkbox"/>	Best Management Practices will be followed to prevent erosion
Does the proposed project alter, excavate or otherwise disturb land area consistent with other land use and habitat area?	<input type="checkbox"/>	<input checked="" type="checkbox"/>	<input type="checkbox"/>	
Is the proposed project likely to impact local seismicity?	<input type="checkbox"/>	<input checked="" type="checkbox"/>	<input type="checkbox"/>	
If the project involved disturbance of surface soils, are erosion and storm water control measures addressed?	<input checked="" type="checkbox"/>	<input type="checkbox"/>	<input type="checkbox"/>	Best Management Practices will be followed for oil and gas standards. The trenching will be limited to the adjacent location.
Air Quality				
Does the proposed action present potential for impacts on ambient air quality under both normal and accident conditions?	<input type="checkbox"/>	<input checked="" type="checkbox"/>	<input type="checkbox"/>	
Are potential emissions (gases and/or airborne particulates including dust) outside of the normal scope for oil field operations?	<input type="checkbox"/>	<input checked="" type="checkbox"/>	<input type="checkbox"/>	
Does the project present risk to human health and the environment from exposure to radiation and hazardous chemicals in emissions?	<input type="checkbox"/>	<input checked="" type="checkbox"/>	<input type="checkbox"/>	
Is the project subject to New Source Performance Standards?	<input type="checkbox"/>	<input checked="" type="checkbox"/>	<input type="checkbox"/>	
Is the project subject to National Emissions Standards for Hazardous Air Pollutants?	<input type="checkbox"/>	<input checked="" type="checkbox"/>	<input type="checkbox"/>	
Is the project subject to emissions limitations in an Air Quality Control Region?	<input type="checkbox"/>	<input checked="" type="checkbox"/>	<input type="checkbox"/>	

NEPA COMPLIANCE SURVEY

	Impacts Anticipated?			If YES, then complete below.
	Yes	No	NA	If the anticipated impact might be unacceptable, recommend mitigation measures:
Wildlife and Habitat				
Does the proposed action present potential for impacts on wildlife or habitat?	<input type="checkbox"/>	<input checked="" type="checkbox"/>	<input type="checkbox"/>	
Does the project impact state or federally listed threatened and endangered species?	<input type="checkbox"/>	<input checked="" type="checkbox"/>	<input type="checkbox"/>	
Human Health Effects				
Does the proposed project present potential for effects on human health? e.g.: Hanta virus, radiological exposure, or chemical exposure (must provide MSDS)	<input type="checkbox"/>	<input checked="" type="checkbox"/>	<input type="checkbox"/>	
Transportation				
Does the proposed project involve transportation of radiological sources or hazardous materials (including explosives)?	<input type="checkbox"/>	<input checked="" type="checkbox"/>	<input type="checkbox"/>	
Waste Management and Waste Minimization				
Are pollution prevention and waste minimization practices needed in the proposed project?	<input checked="" type="checkbox"/>	<input type="checkbox"/>	<input type="checkbox"/>	Best Management Practices will be followed to prevent erosion of silt and soils. The contaminated soils will be transferred to the landfarm. Clean fill dirt will be used for replacement. The area will be compacted and reseeded. Any hazardous materials used on location will be segregated and burned to prevent contamination.
Does project plan establish procedures in compliance with local, state and/or federal laws and guidelines affecting the generation, transportation, treatment, storage or disposal of hazardous and other wastes?	<input type="checkbox"/>	<input checked="" type="checkbox"/>	<input type="checkbox"/>	

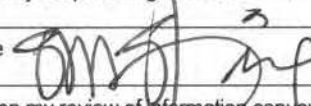
NEPA COMPLIANCE SURVEY

	Impacts Anticipated?			If YES, then complete below.	
Cultural Impact	Yes	No	NA	If the anticipated impact might be unacceptable, recommend mitigation measures:	
Is there potential for impact on cultural (historic) resources?	<input type="checkbox"/>	<input checked="" type="checkbox"/>	<input type="checkbox"/>	This area has been reviewed by an archologist and with no impact	
Community Impact	Yes	No	NA	If the anticipated impact might be unacceptable, recommend mitigation measures:	
Will the proposed project introduce significantly adverse auditory, visual, or other impact?	<input type="checkbox"/>	<input checked="" type="checkbox"/>	<input type="checkbox"/>		
Will the proposed project adversely affect the community's use of public land/resources?	<input type="checkbox"/>	<input checked="" type="checkbox"/>	<input type="checkbox"/>		
Will the proposed project adversely affect the community's access to private land?	<input type="checkbox"/>	<input checked="" type="checkbox"/>	<input type="checkbox"/>		
NOTE: Topography Map and Wetlands Map are required to be attached. Attach applicable SOPs for Risk Assessment Level 2 & 3 and specific test procedures.					
Are permits required? If YES, list below:				Yes <input checked="" type="checkbox"/> No <input type="checkbox"/>	
trenching					
Section below to be reviewed by Environmental Specialist and DOE NCO.					
Adequate Mitigation Measures Provided?			Adequate Mitigation Measures Provided?		
	Yes	No		Yes	No
Water Quality Impacts	<input checked="" type="checkbox"/>	<input type="checkbox"/>	Transportation Impacts	<input checked="" type="checkbox"/>	<input type="checkbox"/>
Air Quality Impacts	<input checked="" type="checkbox"/>	<input type="checkbox"/>	Waste Management Impacts	<input checked="" type="checkbox"/>	<input type="checkbox"/>
"Wildlife and Habitat Impacts	<input checked="" type="checkbox"/>	<input type="checkbox"/>	Cultural Impacts	<input checked="" type="checkbox"/>	<input type="checkbox"/>
Geology and Soils Impacts	<input checked="" type="checkbox"/>	<input type="checkbox"/>	Community Impact	<input checked="" type="checkbox"/>	<input type="checkbox"/>
Human Health Impacts	<input checked="" type="checkbox"/>	<input type="checkbox"/>	Categorical Exclusion	<input checked="" type="checkbox"/>	<input type="checkbox"/>
Approvals					
Comments and Conditions:	B5.2 Modifications to oil, gas, and geothermal facility pump and piping configurations, manifolds, metering systems, and other instrumentation that would not change design process flow rates or affect permitted air emissions B5.4 Repair or replacement of sections of a crude oil, produced water, brine, or geothermal pipeline, if the actions are determined by the Army Corps of Engineers to be within the maintenance provisions of a DOE permit under section 404 of the Clean Water Act				
Contractor ESS&H	S. Shire 			Date 1-29-2010	
Comments and Conditions:	Based on my review of information conveyed to me and in my possession (or attached) concerning the proposed action, as NEPA Compliance Officer (as authorized under DOE Order 451.1A), I have determined that the proposed action fits within the specified class of actions, the other regulatory requirements set forth above are met, and the proposed action is hereby categorically excluded from further NEPA review.				
DOE NEPA Compliance Officer	CXB 5.2 			Date 2/1/10	

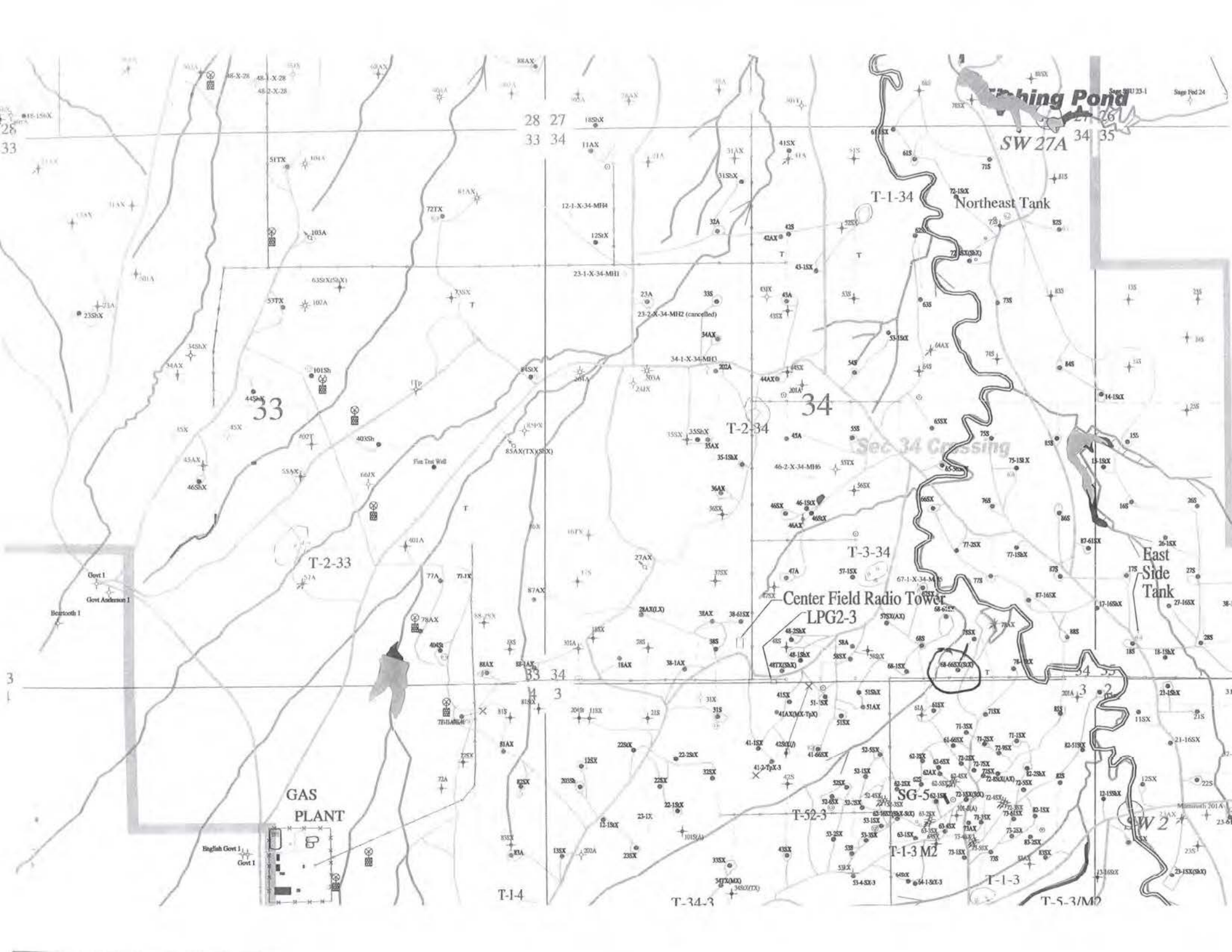

Fishing Pond

SW 27A

Northeast Tank

Sec 34 Crossing

Center Field Radio Tower
LPG2-3

East Side Tank

GAS PLANT

English Govt 1
Govt 1

T-1-4

T-34-3

T-52-3

T-1-3 M2

T-1-3

T-5-3/M2