

PRAIRIE VIEW RDF



Prairie View RDF



- Located at JAAP (approx. 40 miles southwest of Chicago), 223 acres on 455 Acre Parcel
- Will County Owner; Waste Management, Operator
- Maximum 23-Year Life

WM/Will County Methane to Energy Plant



- Landfill Contract Signed w/WM in 1997 w/Gas-to-Energy Plant Clause
- County Retains Gas Rights &WM Installs Gas Collection System
- WM owns Methane to Energy Plant &Tax Credits

CONTRACT PHASE

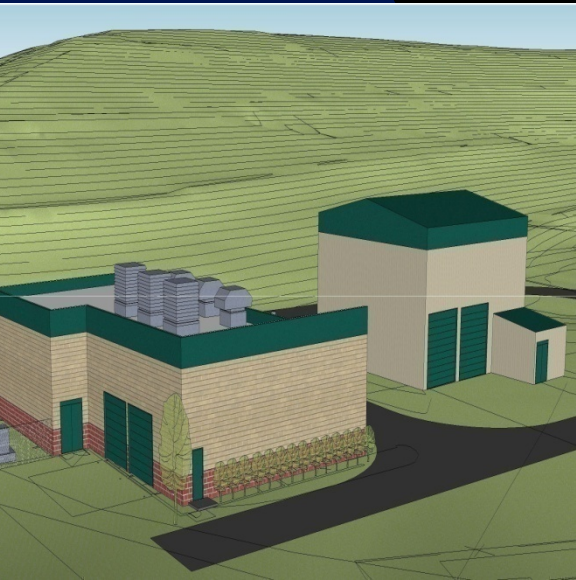

- DOE Grant Applied 6/09
- County Board Approves DOE EECBG Strategy 11/09
- 1 Million DOE Funds to Methane to Energy Plant
- Schiff Harden Hired to Negotiate Gas to Energy Contract
- February 2010 County Board Authorizes Contract Execution

METHANE TO ENERGY PLANT DETAILS



- Waste Management Required To Meet Milestone Timeframes
- Initially (3) 1.6 MW CAT 3520 Engines, 12.8 MW When Fully Built
- Construction Begins Fall 2010; Waste Management Completed Construction Summer 2011, ComEd(Utility) December 2011
- Easement Negotiation Winter 2011

WM/Will County Methane to Energy Plant



- Commissioning December 2011
- Operational Winter 2011/2012
- Electricity to Power 3,000 Initially, 8,000 Homes When Fully Built; Capture GHG, Revenue for County 20+ years
- Revenue Estimated @ \$441,000 Annually (1st year – Based Upon Gas Generated)

WM/Will County Methane to Energy Plant



- County is paid for gas, WM Sells Electricity, Excess Gas Flared Until New Engine(s) Are Permitted
- Gas Payments, Revenue Sharing; Guarantees of Performance
- Public/Private Partnership: WM Builds/Operates; County Project Management

WM/Will County Methane to Energy Plant



- Leachate Recirculation Allowed by County (Previously Prohibited)
- Creates 30% More Gas Quicker, Decomposition of Waste, Potential Benefits in Post-Closure Care,
- Additional Airspace = Revenue
- Estimated Cost of Plant: Over \$9 Million

WM/Will County Methane to Energy Plant

Lessons Learned & Positive Reflections:

- Select an Experienced Contractor (i.e. WM): WM Installs/Manages Gas System & Plant
- Look at Both Sides When Negotiating Contract
- Allow for Flexibility in Contract if Markets Fluctuate (i.e. After 4th Engine is Placed)



What Made It Happen?



- Why Did WM & County Board Become Partners Again?
- What Factors Made the Contract Happen?
- County Board Sees Big Picture (Energy & \$)
- County & WM Work Together to Implement Project
- Included Critical Deadlines to Keep Project Moving

WM/Will County Methane to Energy Plant



- WM Pays Utility a Premium to Be More Responsive to the Project
- WM Built in Time for Additional Permits (Air, Land); Approvals
- WM's Experience w/ 50+ GTE Projects, Financially Solvent
- WM Pushes Utility w/ County's Help
- WM Meets Critical Milestones

WM/Will County Methane to Energy Plant



- Result: Positive Long Term Project for Will County & Waste Management: Produce Green Power, Make Revenue (and no cost to County)
- Dept. of Energy Funds Spurred Plant to Be Built Faster; Helped Sell Project; County Did Not Need to Use Its Funds

BENEFITS



- PR: National Recognition for WM & Will County
- \$8+ Million Leveraged, \$1 million investment from DOE Grant = \$20 - \$30 million of revenue over 30 year period
- County now has another revenue source to consider funding green projects for 20 -30 years.
- Landfill revenue in 2012 is continuing Environmental Education, Grant Related Projects, which started under the EECBG

BENEFITS (cont)



- Landfill Revenue May Also Provide:
- Seed \$\$ For Grants for Additional Renewable Energy Projects
- Energy Efficiency Projects for County, local entities
- 2012 - 2025 Energy & Conservation Plan to Be Implemented This Year; Recommends Utilizing Landfill Funds For Future Energy Efforts

WM/Will County Methane to Energy Plant

Contact Information:

Dean Olson, Director

Will County Land Use Dept,
Resource Recovery & Energy
Division

dolson@willcountygreen.com

(815) 774-7891